

# Zen 7232 SD Platinum Air 72" x 32" x 23"

SKU: ZEN7232SD-PAIR



## TECHNICAL SPECIFICATIONS

Drain	Side drain
Pump Location(s): Select 2	Std. = Standard / Alt LF/RF Optional
Bath Weight (empty)	185 lbs
Gallons to Operate	67-85

## ELECTRICAL SPECIFICATIONS

Motor/Pump	(1) 115v 20AMP GFCI Circuits
Whisper Flo Heat Pump System	(2) 115v 20AMP GFCI Circuit

## STANDARD FEATURES & ACCESSORIES for PLATINUM AIR

### JETS

34 EZ Clean Air Jets

HTT Leg Therapy Air Massage Jets **X**

HTT Back Therapy Air Massage Jets **X**

### PUMPS

1.25 Air Power Variable Speed, Pulse & Wave heated Air Pump

Quiet Pad Anti-Vibration Mounted Pump

Whisper Flo Heat Pump System with Control & Ecobond Foam Insulation  
(must select Pump Locations)

### HEATERS

Stainless Steel Electric Heater

Warm Back Rest Tubing Zone

### CONTROLS

Air Switch On/Off Control(s) for Chromatherapy & Whisper Flo Heat Pump

Variable Speed Air Massage Control

Automatic Purge & Dry Cycle Control

### PURITY

HydroClean Water Purity System

HydroCleanse

## BATHERS: 2

### INSTALLATION

•	DECK (D)
•	UNDER MOUNT (U)
•	ALCOVE (A)
	FREESTANDING (F)
	CLAWFOOT (L)
	PEDESTAL (P)

Jet &  
Control  
placement  
may vary



## STANDARD ACCESSORIES

Grab Bar(s) - 1-on Side Drain Baths - White, Biscuit, Bone,  
Brushed Nickel, Polished Chrome

Chromatherapy Lighting

Deluxe Cable Drain - White, Biscuit, Bone, Brushed Nickel,  
Oil Rubbed Bronze, Polished Chrome,

Deluxe Cushion Pillow

EZ Level Base

FDA Recipe Non-Toxic Food & Beverage Grade  
Plumbing (primarily)

30 Point Quality Assurance Factory Test

## REQUIREMENTS

Pump Locations: Select 2

Electrical: Three 115v 20AMP GFCI Circuits

Drain and Grab Bars: Select Color / Finish

**Tub should not be supported by the lip in any way.**

**Level tub & screw or glue EZ Level adjustable legs to sub floor.**

### CUT OUT DIMENSIONS:

**OVALS:** A template will be provided

**RECTANGLES:** Subtract 1" to 1.5" from length & width for hole  
cut out size

**EZ CLEAN CAST ACRYLIC  
LIMITED LIFETIME WARRANTY**



- A** **X** HTT® Leg Therapy Air Massage System includes 10 Air Jets on the floor. Optional on Combo Plat and Combo Gold Series
- B** **X** 6 Jet HTT® Back Massage System: N/A on Combo Series-Standard on Plat series
- C** **W** Warm Back Tubing Zone

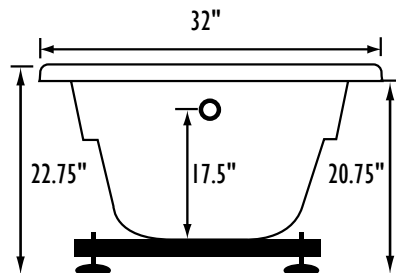
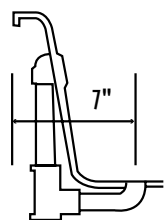

square  
lip profile

Bath includes EZ Level Base

**INSTALLATION WILL NOT REQUIRE MORTAR BEDDING**

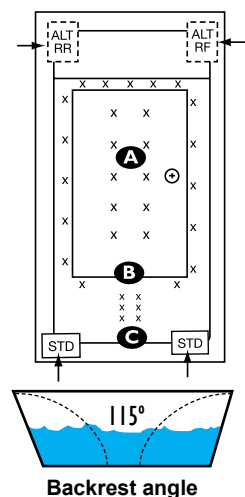

Backrest angle

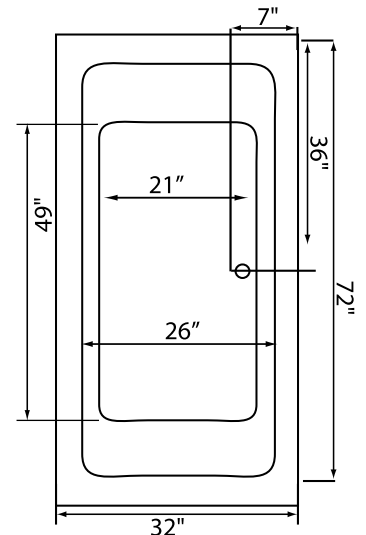

Some standard & most alternate pump locations may stickout past perimeter of the bath 1"-3". **NOTE:** Graphics may not be to scale. Specifications and features are subject to change without notice and are  $\pm .25"$ . All final measurements should be taken from tub on site. Access 18"x 18" or larger is required for each pump. Consult your contractor for installation requirements.