

# Zen 6642 SD Platinum Water Jet

66" x 42" x 23"

SKU: ZEN6642SD-PWJ



## TECHNICAL SPECIFICATIONS

Drain	Side drain
Pump Location(s): Select 2	Std. = Standard / Alt LF/RF Optional
Bath Weight (empty)	180 lbs
Gallons to Operate	57-83

## ELECTRICAL SPECIFICATIONS

Motor/Pump	(2) 115v 20AMP GFCI Circuits
Inline Stainless Steel Heater	(1) 115v 20AMP GFCI Circuit

## BATHERS: 2

### INSTALLATION

• DECK (D)
• UNDER MOUNT (U)
• ALCOVE (A)
• FREESTANDING (F)
• CLAWFOOT (L)
• PEDESTAL (P)

## PLATINUM WATER JET

Jet &  
Control  
placement  
may vary



## STANDARD FEATURES & ACCESSORIES for PLATINUM WATER JET

### JETS

20 Water Jets  
Back Massage System(s) (7 Jets)  
Neck Massage Pillow (2 Jets)   
Sole Soother Jet(s)   
Accumassage Back, Neck   
Ultra Flow Jets

### PUMPS

Two 3.25 Hydrowave 3-speed Pumps (Side Drain Baths)  
Quiet Pad Anti-Vibration Mounted Pump

### HEATERS

Stainless Steel Electric Heater

### CONTROLS

Air Switch On/Off Control(s) For Chromotherapy Lighting  
Air Switch On/Off with digital Temperature Readout Control  
3 Speed Massage: High, Medium or Low

### PURITY

HydroClean Water Purity System  
HydroCleanse

### STANDARD ACCESSORIES

Grab Bar(s) - 1 on Side Drain baths  
White, Biscuit, Bone, Brushed Nickel, Polished Chrome  
Chromotherapy Lighting  
Deluxe Cable Drain - White, Biscuit, Bone, Brushed Nickel,  
Oil Rubbed Bronze, Polished Chrome  
Deluxe Cushion Pillow on two person baths  
Neck Massage Pillow  
EZ Level Base  
FDA Recipe Non-Toxic Food & Beverage Grade Plumbing (primarily)  
30 Point Quality Assurance Factory Test

### REQUIREMENTS

Pump Location(s): Select 2  
Electrical: three 115v 20AMP GFCI Circuits  
Drain and Grab Bars: Select Color / Finish  
**Tub should not be supported by the lip in any way.**  
**Level tub & screw or glue EZ Level adjustable legs to sub floor.**  
**CUT OUT DIMENSIONS:**  
**OVALS:** A template will be provided  
**RECTANGLES:** Subtract 1" to 1.5" from length & width for hole cut out size

**EZ CLEAN CAST ACRYLIC** **US ANSI**  
**LIMITED LIFETIME WARRANTY**

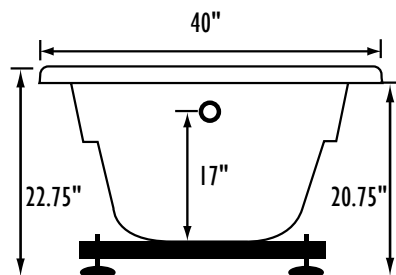
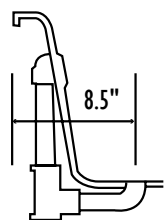

square  
lip profile

Bath includes EZ Level Base

**INSTALLATION WILL NOT REQUIRE MORTAR BEDDING**

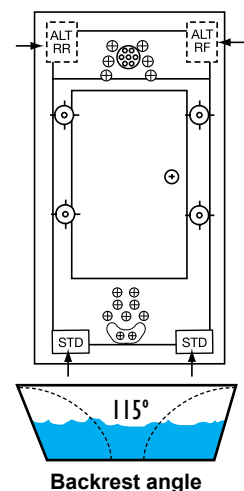

Backrest angle

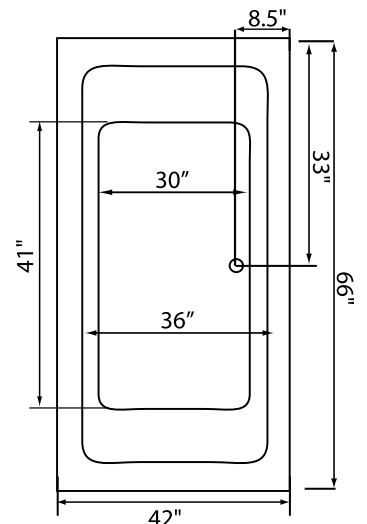

Some standard & most alternate pump locations may stickout past perimeter of the bath 1"-3". **NOTE: Graphics may not be to scale.**  
Specifications and features are subject to change without notice and are  $\pm .25"$ . All final measurements should be taken from tub on site.  
Access 18"x 18" or larger is required for each pump. Consult your contractor for installation requirements.