

# Zen Oval 6636 Gold Water Jet 66" x 36" x 24"

SKU: ZENOVAL6636-GWJ



| TECHNICAL SPECIFICATIONS      |                                      |
|-------------------------------|--------------------------------------|
| Drain                         | End drain                            |
| Pump Location(s): Select 1    | Std. = Standard / Alt LF/RF Optional |
| Bath Weight (empty)           | 165 lbs                              |
| Gallons to Operate            | 66-84                                |
| ELECTRICAL SPECIFICATIONS     |                                      |
| Motor/Pump                    | (1) 115v 20AMP GFCI Circuits         |
| Inline Stainless Steel Heater | (1) 115v 20AMP GFCI Circuit          |

| BATHERS: 1   |                  |
|--------------|------------------|
| INSTALLATION |                  |
| •            | DECK (D)         |
| •            | UNDER MOUNT (U)  |
|              | ALCOVE (A)       |
|              | FREESTANDING (F) |
|              | CLAWFOOT (L)     |
|              | PEDESTAL (P)     |

## GOLD WATER JET

Jet &  
Control  
placement  
may vary



## STANDARD FEATURES & ACCESSORIES for GOLD WATER JET

### JETS

12 Water Massage Jets  
Back Massage System(s) (6 Jets)  
Accumassage Back and Neck Jets ⊕  
6 Ultra Flow Jets ⊕

### PUMPS

3.25 Hydropower 3-speed Pump  
Quiet Pad Anti-Vibration Mounted Pump

### HEATERS

Stainless Steel Electric Heater

### CONTROLS

Air Switch On/Off Control(s) For Hydro Pump & Mood Light  
3 Speed Massage: High, Medium or Low

### PURITY

HydroClean Water Purity System  
HydroCleanse

## STANDARD ACCESSORIES

Mood Light  
Lift & Turn Drain - White, Biscuit, Bone, Brushed Nickel,  
Oil Rubbed Bronze, Polished Chrome  
Deluxe Cushion Pillow  
EZ Level Adjustable Legs  
FDA Recipe Non-Toxic Food & Beverage Grade Plumbing (primarily)  
30 Point Quality Assurance Factory Test

## REQUIREMENTS

Pump Locations: Select 1  
Electrical: two 115v 20AMP GFCI Circuits  
Drain: Select Color / Finish

**Tub should not be supported by the lip in any way.**

**Level tub & screw or glue EZ Level adjustable legs to sub floor.**

### CUT OUT DIMENSIONS:

**OVALS:** A template will be provided

**RECTANGLES:** Subtract 1" to 1.5" from length & width for hole cut out size

**EZ CLEAN CAST ACRYLIC  
LIMITED LIFETIME WARRANTY**

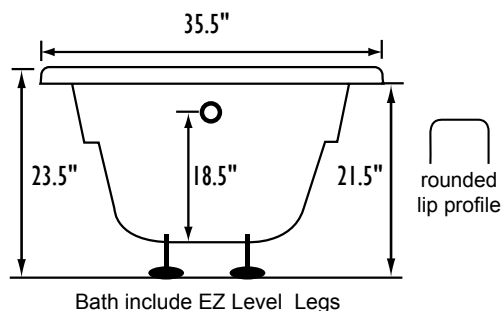
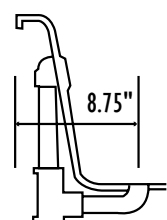

**INSTALLATION WILL NOT REQUIRE MORTAR BEDDING**

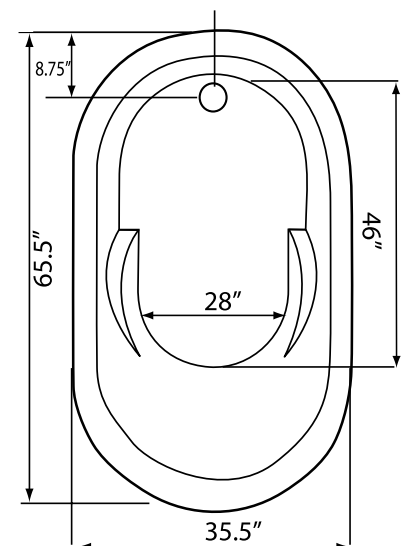
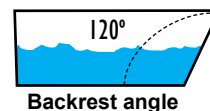
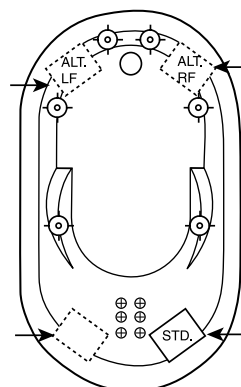

Some standard & most alternate pump locations may stickout past perimeter of the bath 1"-3". NOTE: Graphics may not be to scale. Specifications and features are subject to change without notice and are ± .25". All final measurements should be taken from tub on site. Access 18"x 18" or larger is required for each pump. Consult your contractor for installation requirements.