

# Zen Oval 7236 SD Silver Water Jet

72" x 36" x 23"

SKU: ZENOVAL7236SD-SWJ



## SILVER WATER JET

### TECHNICAL SPECIFICATIONS

Drain	Side drain
Pump Location(s): Select 1	Std. = Standard / Alt LF/RF Optional
Bath Weight (empty)	160 lbs
Gallons to Operate	77-102

### ELECTRICAL SPECIFICATIONS

Motor/Pump	(1) 115v 20AMP GFCI Circuits
Inline Stainless Steel Heater	(Opt) 115v 20AMP GFCI Circuit

### BATHERS: 2

### INSTALLATION



• DECK (D)
• UNDER MOUNT (U)
ALCOVE (A)
FREESTANDING (F)
CLAWFOOT (L)
PEDESTAL (P)

Jet & Control placement may vary



### STANDARD FEATURES & ACCESSORIES for SILVER WATER JET

#### JETS

9 Water Jets  
Tri-Zone Back Systems 3 Jets  
Ultra Flow Jets   
Micro Flow Jets 

#### PUMPS

2.25 Hydropower 1-speed Pump  
Quiet Pad Anti-Vibration Mounted Pump

#### CONTROLS

Air Switch On/Off Control(s)

#### PURITY

HydroClean Water Purity System  
HydroCleanse

#### STANDARD ACCESSORIES

FDA Recipe Non-Toxic Food & Beverage Grade  
Plumbing (primarily)  
30 Point Quality Assurance Factory Test  
EZ Level Adjustable Legs

### REQUIREMENTS

Pump Locations: Select 1

Electrical: one 115v 20AMP GFCI Circuits

**Tub should not be supported by the lip in any way.**

**Level tub & screw or glue EZ Level adjustable legs to sub floor.**

**CUT OUT DIMENSIONS:**

**OVALS:** A template will be provided

**RECTANGLES:** Subtract 1" to 1.5" from length & width for hole cut out size

### EZ CLEAN CAST ACRYLIC

LIMITED LIFETIME WARRANTY

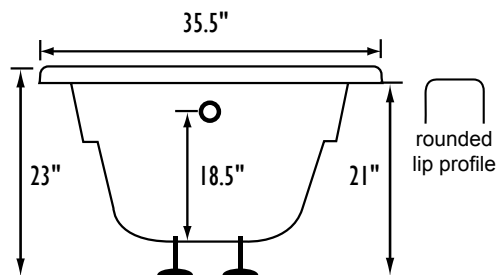
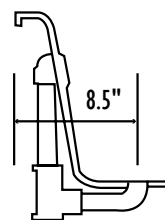

Bath includes EZ Level Legs

**INSTALLATION WILL NOT REQUIRE MORTAR BEDDING**

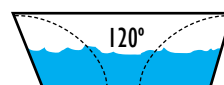
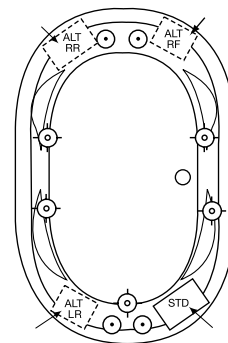

Backrest angle

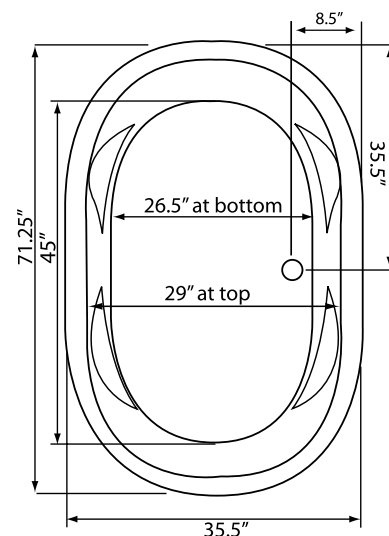

Some standard & most alternate pump locations may stickout past perimeter of the bath 1"-3". NOTE: Graphics may not be to scale. Specifications and features are subject to change without notice and are  $\pm .25"$ . All final measurements should be taken from tub on site. Access 18"x 18" or larger is required for each pump. Consult your contractor for installation requirements.